

ZÁVITOVÁ KONCOVKA VOĽNÁ, BSP ZÁVIT, S PLOCHÝM TESNENÍM

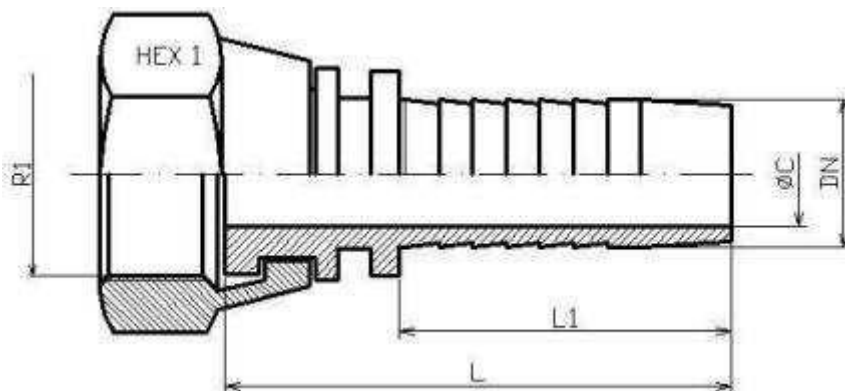

Materiál: uhlíková ocel' alebo nerez

DN	R1	L	L1	HEX 1	ØC
1/4"	1/4" BSP	41	28	19	4
5/16"	3/8" BSP	43	28	22	5,5
3/8"	3/8" BSP	44,5	29,5	22	7
3/8"	1/2" BSP	44,5	29,5	27	7
1/4"	1/2" BSP				
1/2"	1/2" BSP	45	30,5	27	9,5
1/2"	3/4" BSP	48	30,5	32	9,5
3/4"	3/4" BSP	59	39	32	15
1"	1" BSP	69	47	41	19
1" 1/4	1" 1/4 BSP	79,5	54,5	50	26
1" 1/2	1" 1/2 BSP	83,5	58	55	32