

ZÁVITOVÁ KONCOVKA PRIAMA, NPT VONKAJŠÍ ZÁVIT KUŽELOVÝ

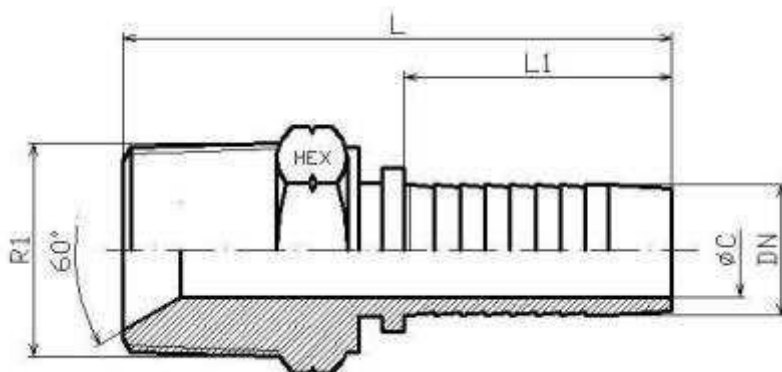

Materiál: uhlíková oceľ alebo nerez

DN	R1	L	L1	HEX 1	ØC
3/16"	1/8" NPT	44,5	24	14	3
1/4"	1/8" NPT	49	28	14	4
3/16"	1/4" NPT	49	24	14	3
1/4"	1/4" NPT	53,5	28	14	4
5/16"	1/4" NPT	53,5	28	14	5,5
3/8"	1/4" NPT	55,5	29,5	17	7
1/4"	3/8" NPT	55	28	19	4
5/16"	3/8" NPT	55	28	19	5,5
3/8"	3/8" NPT	57	29,5	19	7
1/2"	3/8" NPT	57,5	30,5	19	9,5
3/8"	1/2" NPT	61,5	29,5	22	7
1/2"	1/2" NPT	62	30,5	22	9,5
5/8"	1/2" NPT	67,3	34	22	12
1/2"	3/4" NPT	65,5	30,5	30	9,5
5/8"	3/4" NPT	70,3	34	30	12
3/4"	3/4" NPT	78	39	30	15
1"	3/4" NPT	85	47	27	19
3/4"	1" NPT	81	39	36	15
1"	1" NPT	89	47	36	19
1"	1"1/4 NPT	96	47	46	19
1"1/4"	1"1/4 NPT	105	54,5	46	26
1"1/4"	1"1/2 NPT	102,5	54,5	50	26
1"1/2"	1"1/2 NPT	106	58	50	32
1"1/2"	2" NPT	113,5	58	65	32
2"	2" NPT	127,5	72,5	65	44